

Midland Redevelopment (Subtracted Area) Regulations 2011

Made by the Governor in Executive Council.

1. Citation

These regulations are the *Midland Redevelopment (Subtracted Area) Regulations 2011*.

2. Commencement

These regulations come into operation as follows —

- (a) regulations 1 and 2 — on the day on which these regulations are published in the *Gazette*;
- (b) the rest of the regulations — on the day after that day.

3. Terms used

In these regulations —

order means an order made under regulation 5(2);

scheme means either of the following —

- (a) the Metropolitan Region Scheme;
- (b) the *City of Swan Local Planning Scheme No. 17*.

4. Schedule 1 of the Act amended

When an order takes effect, in Schedule 1 of the Act:

- (a) delete “Plan No. 1” (first occurrence) and insert:

Plan No. 2

- (b) delete “Plan No. 1 —” and insert:

Plan No. 2 —

- (c) delete the representation of Plan No. 1 and insert:

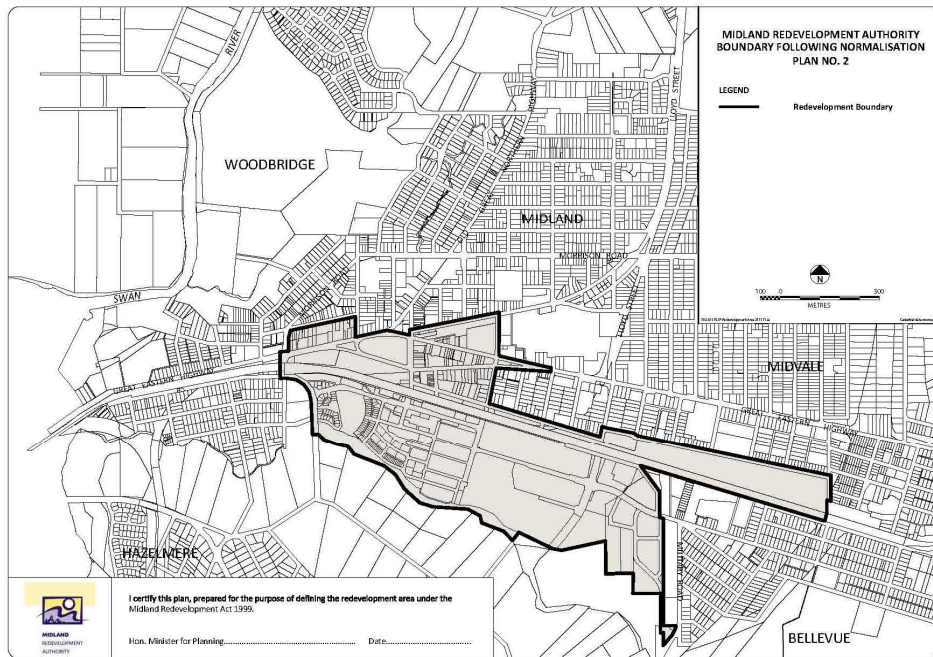

5. Minister may amend planning schemes

- (1) In this regulation —

subtracted area means the area that ceases to be in the redevelopment area when Schedule 1 of the Act is amended by regulation 4.
- (2) The Minister may, by order published in the *Gazette*, amend a scheme to provide for any of the following —
 - (a) land in the subtracted area to be included in the area to which the scheme applies;
 - (b) land in the subtracted area to have a reservation or zoning under the scheme the same as, or similar to, that which applied to the land immediately before it ceased to be in the redevelopment area.
- (3) An order takes effect at the beginning of the day after the day on which it is published in the *Gazette*.

6. Other transitional matters

When an order takes effect, the effect of a decision, if any, previously made by the Authority about a development application or an approval continues.

7. Expiry of regulations

- (1) These regulations expire at the end of the 12 month period following the day on which these regulations came into operation.

- (2) The expiry of these regulations does not affect —
- (a) the amendment of the redevelopment area under regulation 4; or
 - (b) an amendment of a scheme under an order.

By Command of the Governor,

R. KENNEDY, Clerk of the Executive Council.
