

PUBLIC

Tabled EV
Committee
Mr Jim Hopkins
Pet 25 Hedding
23/09/09.

ESPERANCE RESIDENTIAL COLLEGE

Date: September 2009

Doug Murray Drive, Esperance WA 6450

Telephone: (08) 9071 9660
Fax: (08) 9071 9667
Email: esperance.residentialcollege@det.wa.edu.au
www: www.erc.edu.au

Manager: Mr Peter Jarzabek
College Board Chairperson: Ms Dianne Rawlinson

Student Accommodation 2009 (figures in red relate to configuration after additions in 2010).

	Single Rooms	Shared Rooms	Temp. Rooms	Total
Boys	7 (13)	32	13 (8)	52 (53)
Girls	7 (13)	32	8 (0)	47 (45)
Totals	14 (26)	64	21 (8)	99 (98)

Enrolment 2004 - 2009 (as at 28 February 2009)

	2004	2005	2006	2007	2008	5 Yr Av.	2009
Yrs 8 - 9	23	40	42	40	39	37	34
Yrs 10 - 12	51	56	64	58	59	57	56
Totals	74	96	106	98	98	94	90

Partner Schools

- Esperance Senior High School: (Yr 8 – 12)

Planning Status

Demand for boarding places is in excess of the permanent boarding capacity. The college has insufficient single bedrooms for year 10, 11, 12 students. Lightframe additions without ablutions need to be replaced, the indoor recreation spaces need to be reconfigured, the kitchen, food stores and laundry need to be upgraded and additional accommodation for live-in boarding staff is needed.

An improvement plan has been developed. Significant funding is needed to undertake the needed works.

Public Private Status

Potential for public - private arrangements. New private school established in Esperance in 2009, currently providing to year 10.

Discussions have been held but no proposals have been presented for consideration.

Esperance Residential College – Asset Planning Report: 23 September, 2009

The prospect of a significant increase in demand for boarding places at the Esperance Residential College was noted by the Country High School Hostels Authority in 2005 when it appeared that a new nickel mining venture would be supported with a local workforce in Hopetoun.

Initial planning was undertaken in relation to a need for in excess of 140 boarding places. The scope of works was reviewed each year as more accurate data became available about the likely increase in demand flowing from the Ravensthorpe District High School.

Department of Education data indicated that between 45 and 60 extra boarding places could be needed.

On this basis initial planning related to works that would support growth in the boarding population from 76 to 140 students.

In the meantime, a change to the school leaving age, the loss of subsidised travel to metropolitan boarding options and recognition of the quality of education on offer in Esperance resulted in an increase in the boarding population from 76 to between 90 and 100 students. In recent years three light frame rooms have been attached to the college to boost the number of boarding places.

The decommissioning of the Ravensthorpe Nickel Mine in 2008 led to a revision of the plans and submission for funds for additions and improvements consistent with a boarding population of 114 students.

Following the emergence of a global economic downturn, no funding was available for new capital projects in 2008-09.

On 3 September 2009 the Minister for Education approved the immediate use of capital funds (\$1.5 million) to undertake works consistent with the asset development masterplan for the Esperance Residential College. These works include twelve new individual bedrooms at the front of the residential college complete with ablutions and one new staff flat.

Further planned improvements include the addition of a further 24 individual student bedrooms; a larger kitchen and dining room, new food stores, a new laundry, improvements to existing ablution blocks, new recreation rooms, new staff accommodation and a new entry. These works will be costed and form part of an asset improvement submission which is being developed in accordance with new capital planning and submission requirements.



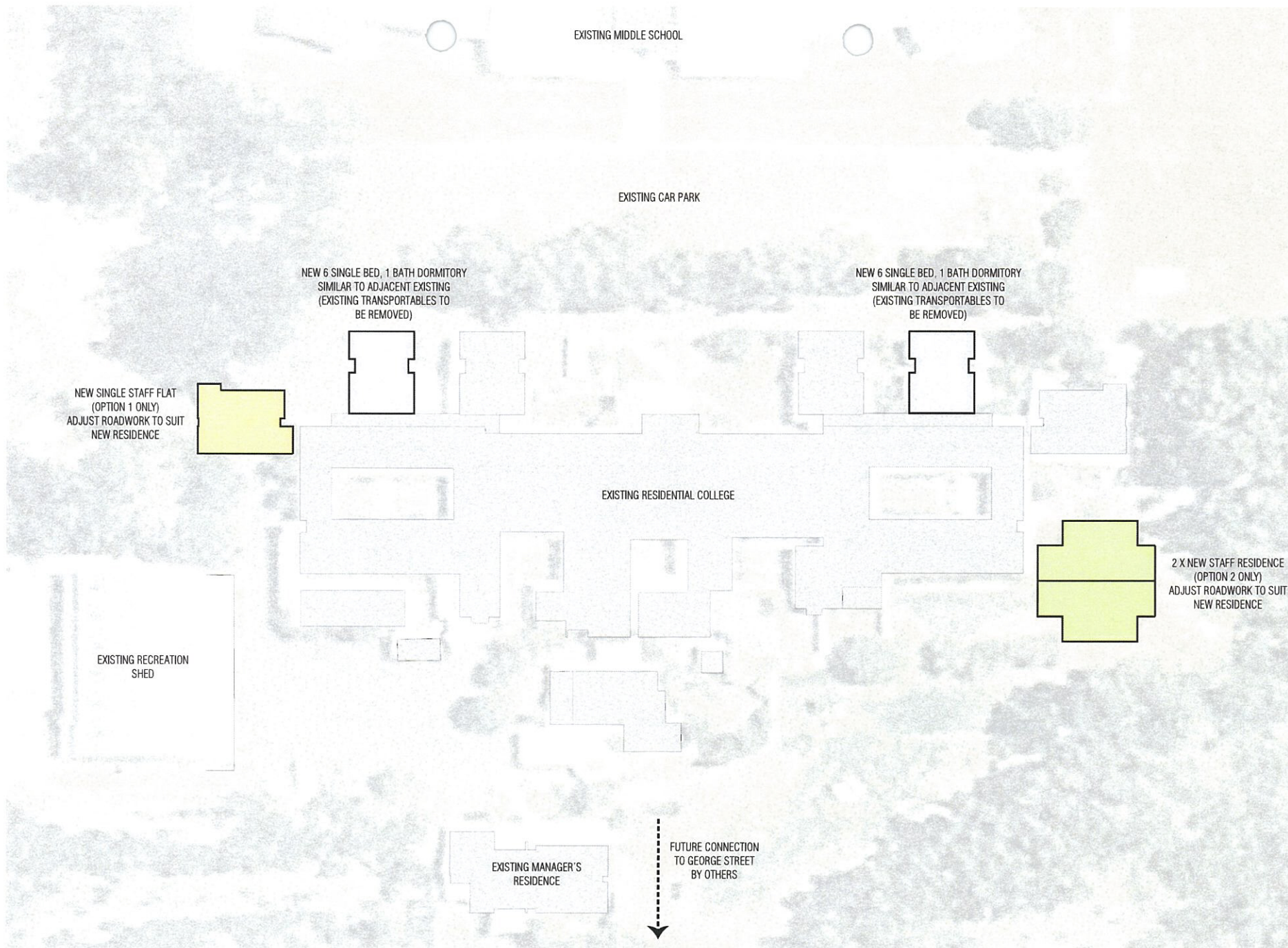

Project
ESPERANCE RESIDENTIAL COLLEGE

Drawing
SITE PLAN

Drawing No
SK-01

Project No
PPA 0461

Date
18/08/2009

Scale
1:500 @ A3

Drawn By
CP

HASSELL

PUBLIC